

ATTACHMENT NO 4

National Committee on Uniform Traffic Control Devices

TTC Technical Committee Recommendations

Approved by the NCUTCD Council January 2008 & June 2008

Section	Page	Line	Comment
6A.01	941	07	concur with recommendation that Edit Committee develop uniform language to address similar language elsewhere in the MUTCD to reduce redundancy
6A.01	941	17	do not concur – change to “... while reasonably protecting road users, workers...”
6A.01	941	30	insert the word as follows: “...constraints, cost, and the ...”
6A.01	941	37	replace “can also” with “might” to read “...improvements might be realized...”
6A.01	941	38 - 40	concur with deletion of the sentence beginning with “ The use ...traffic flow. ”
6A.01	941	41 – 50	concur
6A.01	942	09	concur
6B.01	943	3 – 9	concur
6B.01	943	34	number as 1 st of 7 principles
6B.01	943	38	substitute practical for possible – “... as nearly as practical comparable to those...”
6B.01	943	42	concur
6B.01	943	44	number as 2 nd of 7 principles

6B.01	943	48	do not concur
6B.01	943	49 – 50	do not concur. Recommend removal of “ C. Provisions...roadways. ”
6B.01	944	2 - 7	concur
6B.01	944	8	3 rd fundamental principle
6B.01	944	21	4 th fundamental principle
6B.01	944	25	do not concur
6B.01	944	26 - 29	concur
6B.01	944	30	modify to read “ ...Provide worker safety protect road users and workers. ”
6B.01	944	38	5 th fundamental principle
6B.01	944	6 th	fundamental principle
6B.01	944	51	7 th fundamental principle
6C.01	946	3 – 9	concur
6C.01	946	12	concur
6C.01	946	13	insert “ ...flow <u>protecting road users and workers</u> when a ...”
6C.01	946	32	concur
6C.01	947	3	concur
6C.01	947	4	concur – we wish English units was in front of metric
6C.01	947	5 – 7	concur
6C.01	947	13 – 15	concur
6C.02	947	26	concur

- 6C.04 948 6 concur with this insertion: "...are [approximate and](#) for guidance purposes, and should..."
- 6C.04 948 7 - 8 delete sentence "~~These distances... recommended distances.~~ These distances should be adjusted for field conditions if needed by increasing or decreasing recommended distances."
- 6C.04 948 10 -11 concur
- 6C.05 948 23 – 29 do not concur
- 6C.06 949 21 – through end of 6C.15 page 952 - concur
- 6D.01 953 3 – 9 TTC Concur
- 6D.01 953 14 – 21 TTC Concur
- 6D.01 953 22 – 25 TTC Concur
- 6D.01 953 30 – 33 TTC Concur
- 6D.01 953 34 – 35 TTC Does not concur
- 6D.01 953 35 – 36 TTC Concur
- 6D.01 953 42 – 47 TTC Concur
- 6D.01 953 49 TTC Concur with modification – "... conflicts with ~~worksite~~ work vehicles, equipment ..."
- 6D.01 953 51 TTC Concur
- 6D.01 954 1 – 5 TTC Concur
- 6D.01 954 9 TTC Concur
- 6D.01 954 18 – 20 TTC Concur
- 6D.01 954 21 - 24 TTC Concur with modification – delete 2 sentences in lines 21 – 24 and replace with –

“To accommodate the needs of pedestrians, the following considerations should be addressed when temporary pedestrian pathways in TTC zones are designed or modified:

A. Provisions for continuity of paths for pedestrians should be incorporated into the TTC process.

B. Access to transit stops should be maintained.

C. A smooth, continuous hard surface should be provided throughout the entire length of the temporary pedestrian facility. There should be no curbs or abrupt changes in grade or terrain that could cause tripping.

D. The width of the existing pedestrian facility should be provided for the temporary facility if practical. Traffic control devices and other construction materials and features should not intrude into the usable width of the sidewalk, temporary pathway, or other pedestrian facility.”

6D.01 954 27 – 32 TTC Concur

6D.01 954 38 – 42 TTC Concur

6D.01 955 40 – 41 TTC Concur

6D.02 955 51 – 2 From line 51 on page 955 through Line 2 page 956

TTC Concur with modification – “The extent of pedestrian needs, including pedestrians with disabilities, should be determined through engineering judgment or by the individual responsible for each TTC zone situation. ~~Adequate provision should be made for pedestrians with disabilities.~~”

6D.02 956 4 – 8 tabled - TTC Concur with modification –

Line 5 – “...shall include detectable and accessibility features consistent...”

Line 6 – “...the a closed sidewalk pedestrian facility...”

Line 8 – “...the a closed sidewalk pedestrian facility...”

6D.02 956 10 – 14 TTC Concur

6D.02 956 15 – 20 TTC Concur with insertion – “... alternate crossings, path guidance, and sign...”

6D.02 956 21 – 29 TTC Concur

6D.02 956 31 – 33 TTC Concur with modifications

- relocate to end of line 20 in this section

- modify “... the pushbutton it should be equipped with a pushbutton locator tone...”

6D.02 956 34 – 6 From line 34 page 956 through line 6 page 957

TTC Concur with modification

To accommodate the needs of pedestrians with disabilities, the following considerations should be addressed when temporary pedestrian pathways in TTC zones are designed or modified:

A. Provisions for continuity of accessible and detectable paths for pedestrians should be incorporated into the TTC process.

B. Accessible and detectable access to temporary transit stops should be provided.

C. ~~(Blocked routes, alternate crossings, and sign and signal information should be communicated to pedestrians with visual disabilities by providing devices such as audible information devices, accessible pedestrian signals, or barriers and channelizing devices that are detectable to the pedestrians traveling with the aid of a long cane or who have low vision.)~~ Where pedestrian traffic is detoured to a TTC signal, engineering judgment should be

used to determine if pedestrian signals or accessible pedestrian signals should be considered for crossings along an alternate route.

D. When channelization is used to delineate a pedestrian pathway, a continuous detectable edging should be provided throughout the length of the facility such that pedestrians using a long cane can follow it. These detectable edgings should comply with the provisions of Section 6F.71.

E. [delete first sentence] There should be no curbs or abrupt changes in grade or terrain that could cause tripping or be a barrier to wheelchair use. The geometry and alignment of the facility should meet the applicable requirements of the “Americans with Disabilities Act Accessibility Guidelines for Buildings and Facilities (ADAAG)” (see Section 1A.11).

F. [delete first sentence] When it is not possible to maintain a minimum width of 1500 mm (60 in) throughout the entire length of the pedestrian pathway, a 1500 x 1500 mm (60 x 60 in) passing space should be provided at least every 60 m (2004 ft), to allow individuals in wheelchairs to pass.

G. Signs and other devices mounted lower than 2.1 m (7 ft) above the temporary pedestrian pathway should not project more than 100 mm (4 in) into accessible pedestrian facilities.”

6D.03 957 24 – 29 TTC Concur

6D.03 957 39 TTC Concur

6D.03 957 47 – 55 TTC Concur with modification

Line 48 – “All workers, including emergency responders, within...”

Line 49 – “...or to work vehicles and construction equipment...”

Line 53 – “ ... risk exposure, **except as noted in the option below**. A person designated by the employer to be responsible for the worker safety ~~plan~~ shall...”

6D.03 958 2

6D.03 958 4 – 7 TTC Concur – insert at end of line 7 – **“Emergency responders may elect not to wear high visibility apparel when they are directly exposed to risks associated with fire, chemicals or other similar hazards.”**

CHAPTER 6E. FLAGGER CONTROL

Section 6E.01 – Qualifications for Flaggers

6E.01 959 04 Concur

6E.01 959 05 Concur

6E.01 959 06-08 Concur

Section 6E.02 – High-Visibility Safety Apparel

6E.02 959 22-23 Concur

6E.02 959 24-25 Strike “or equivalent revisions”

6E.02 959 26 Concur

6E.02 959 28 Concur

6E.02 959 32-33 Concur

6E.02 959 35-36 Concur

6E.02 959 34 Strike “or equivalent revisions” [in all other areas of this section]

6E.02 959 37 Concur

6E.02 959 38-40 Concur

6E.02 959 41-45 Modify by moving “In lieu of ANSI/ISEA 107-2004 apparel” to beginning of sentence; Strike “or equivalent revisions”

Section 6E.03 – Hand-Signaling Devices

6E.03 959 47-49 Concur

6E.03 960 06-07 Concur

6E.03 960 08 Concur

6E.03 960 10-11 Concur

6E.03 960 13-15 Modify to read “The preferred method of displaying the STOP or SLOW message to approaching traffic is to place the STOP/SLOW paddle on a rigid staff.”

6E.03 960 16-18 Delete

6E.03 960 50-52 Concur

6E.04 961 4 Concur

6E.04 961 5 insert commas to read: “to be remotely operated either by a single flagger, at one end of the TTC zone or at a central location, or by

6E.04 961 6 Concur

6E.04 961 7 Delete

6E.04 961 8 Modify to read: “An AFAD (see Section 6E.05 is a remotely controlled ...”

6E.04 961 9 Concur

6E.04 961 10-12 Delete

6E.04 961 13-22 Concur

- 6E.04 961 23-25 Delete the first sentence: “~~AFADs should only be used when determined to be appropriate based on an engineering study conducted by the agency authorizing their use.~~ Minimum or maximum ... the agency authorizing their use.”
- 6E.04 961 28-32 Modify to read:
Standard:
~~Because AFADs are not traffic control signals, they shall not be used as a substitute for or a replacement for a continuously operating temporary traffic control signal as described in Section 6F.80.~~ AFADs shall meet the crashworthy performance criteria contained in ~~the National Cooperative Highway Research Program (NCHRP) Report 350, “Recommended Procedures for the Safety Performance Evaluation of Highway Features”~~ (see Section 6F.01).
- 6E.04 961 33-40 Concur
- 6E.04 961 40 Delete the word “qualified” to read: “... only by a ~~qualified~~ flagger ...”
- 6E.04 961 41 Concur
- 6E.04 961 42-43 Modify to read: “AFAD(s) unattended at any time while the AFAD(s) is being used. ~~to alternately control the right of way.~~”
- 6E.04 961 44-48 Concur
- 6E.04 962 1 Concur
- 6E.04 962 2 Insert “both” to read: “... (Method 2) if **both** of”
- 6E.04 962 3 Concur
- 6E.04 962 4 Insert “and” at end of line to read: “of the AFAD(s), **and**”
- 6E.04 962 5 Change comma at end of line to period

- 6E.04 962 6 Delete
- 6E.04 962 7-9 Concur
- 6E.04 962 11-12 Change to a standard to read:

Standard:

When an AFAD is not in use, it ~~should~~ **SHALL** be removed from its normal operating position and stored in a manner that reduces the possibility of it being impacted by run-off-the-road vehicles.

- 6E.04 962 16 Insert “based on an engineering study” to read: “A State or local agency that elects to use AFADs should adopt a policy governing AFAD applications”
- 6E.04 962 17-27 Concur

Section 6E.05 - STOP/SLOW Automated Flagger Assistance Devices

- 6E.05 962 28-31 Concur
- 6E.05 962 32-33 Delete wording to read: ~~“STOP/SLOW paddle without the need for a flagger in the immediate vicinity of the AFAD or on the roadway (see Figure 6E.1).~~
- 6E.05 962 34-45 Concur
- 6E.05 962 46-49 Modify to read: ~~“B. A Stop Beacon (see Section 4L.05) mounted no more than 600 mm (24 in) above the STOP face and a~~ Warning Beacon (see Section 4L.03) mounted no more than 600 mm (24 in) above, below, or to the side of the SLOW face. ~~The Stop Beacon shall not be flashed or illuminated when the SLOW face is displayed, and the~~ Warning Beacon shall not be flashed or illuminated when the

6E.05	962	50-51	Concur
6E.05	963	1-9	Concur
6E.05	963	10-11	Modify to read: “If louvers are used, the louvers shall be designed such so that the aspect of the full sign face is displayed to approaching traffic is a full sign face at a distance of 15 m (50 ft) or greater.
6E.05	963	12	Change Guidance to Standard
6E.05	963	13-15	Change to read: “The STOP/SLOW AFAD should shall include a gate arm that descends to a down position across the approach lane of traffic when the STOP face is displayed and then ascends to an upright position when the SLOW face is displayed.”
6E.05	963	16-20	Concur
6E.05	963	21	Delete the 1 st 3 words to read: “ If used, the The gate arm ...”
6E.05	963	22-40	Concur
6E.05	963	41	Modify to read: “STOP face, if used, shall flash or the Stop Beacon shall flash . To permit stopped road users to proceed, the”
6E.05	963	42-43	Concur
6E.05	963	44-45	Modify to read: “If STOP/SLOW AFADs are used to control traffic in a one-lane, two-way TTC zone, safeguards the flagger(s) shall be prevented incorporated to prevent the flagger(s) from simultaneously displaying the SLOW face at each”
6E.05	963	46	Insert “(s)” after flagger to read: “... the flagger (s) shall ...”
6E.05	963	47	Concur

Section 6E.06 Red/Yellow Lens Automated Flagger Assistance Devices

6E.06 963-964 Delete entire section

Section 6E.07 – Flagger Procedures

6E.07 964 47 Concur

6E.07 964 50-53 Concur with the removal of the reference to AFADs, here and throughout this section.

6E.07 965 21-22 Concur

6E.07 965 34-35 Concur

6E.07 965 40 Concur

Section 6E.08 – Flagger Stations

6E.08 965 42 Concur

6E.08 965 52 Concur

Chapter 6F Temporary Traffic Control Devices

6F.01 967 3-9 Concur

6F.01 967 23-41 Concur

6F.02 967 Concur with Section

6F.03 968 Concur with Section

6F.06 970 Concur with Section

6F.08 970 Concur with Section

6F.09	971		Concur with Section
6F.11	971		Concur with Section
6F.12	971		Concur with Section
6F.13	971		Concur with Section
6F.14	972		Concur with Section
6F.15	972		Concur with Section
6F.16	972		Concur with Section
6F.17	973		Concur with Section
6F.18 to 6F.22			Concur with Sections
6F.23	974	39-42	Concur
6F.24 to 6F.29			Concur with Sections
6F.30	975		Concur
6F.31	976	4-10	Concur Do not concur [delete reference noted in line 2]
6F.32 to 6F.43			Concur with Sections
6F.44	978	14 –16	Concur
6F.45	978	28-32	Concur
6F.46	978		Concur
6F.47	978	38-45	modify to read:

Option:

In order to give road users advance notice of a lane shift, a Reverse Curve sign (W1-4) or a sign showing multiple reverse curve symbols may be used (W1-4b, or W1-4c).

Standard:

When multiple reverse curve symbols are displayed, the number of arrows shall be the same as the number of lanes available to road users. The direction of the reverse curve shall be appropriately illustrated.

6F.48 978 38-45 modify to read:

Option:

In order to give road users advance notice of a lane shift, a Reverse Curve sign (W1-4) or a sign showing multiple reverse curve symbols may be used (W1-4b, or W1-4c).

Standard:

When multiple reverse curve symbols are displayed, the number of arrows shall be the same as the number of lanes available to road users. The direction of the reverse curve shall be appropriately illustrated.

6F.49 to 6F.54 Concur with Sections

6F.55 to 6F.56 Concur with Sections

6F.57 981 concur with section; Table 1A-2 be placed within this section; references to PCMS that are in Part 2 be repeated in Part 6

6F.58 985 35 Add “When using an arrow panel on a stationary single lane closure, only one arrow panel shall be used.” to the beginning of the standard 6F.60 986 18-19 TTC Concur

6F.60 986 23 TTC Concur

6F.60 986 25 – 26 TTC Concur

6F.60 986 31 Delete Lines 31 to 36. Add Lines 29 – 36 from Pg 990 to Pg 986, Line 31 with the following revisions:

Standard:

Where channelizing devices are used to channelize pedestrians, there shall be continuous detectable bottom and top surfaces to be detectable to users of long canes. The bottom of the bottom surface shall be no higher than 50 mm (2 in) above the ground. The top of the top surface shall be no lower than 800 mm (32 in) above the ground.

Option:

A gap not exceeding 50 mm (2 in) between the bottom surface and the ground

6F.61	987	38	Editorial
6F.62	988	29 – 33	TTC Concur
6F.62	988	34	TTC Concur with modification: “orange bands placed a maximum of 150 mm (6 in) from the top...”
6F.62	988	36 – 38	note: coordinate with 6D.01
6F.63	989	5 - 15	TTC Concur
6F.64	989	44 – 47	TTC Concur
6F.64	989	49 – 50	TTC Concur with recommendation that this be moved to section 6F.60 and modified to: “Ballast shall not be placed on the top of a channelizing device. Channelizing devices shall not be weighted with sand, water, or any material to the extent that would make them hazardous to road users or workers when struck.”
6F.65	990	7	Editorial
6F.65	990	29-36	Relocated to Pg 986

- 6F.65 990 39-40 Move sentence “Traffic control devices and other construction materials and features shall not intrude into the usable width of the sidewalk, temporary pathway, or other pedestrian facility.” to Pg 986 as part of the Standard statement listed above.
- 6F.65 990 37, 38, 40-43 Move to Pg 986 below Standard statement as a Guidance statement.
- 6F.65 990 44-47 Delete
- 6F.65 990 49 Editorial
- 6F.65 991 1 -2 Editorial
- 6F.65 991 9 TTC Concur with modification “conformance with the manufacturer’s application and installation recommendations ...”
- 6F.65 991 11 – 12 delete 1st sentence; modify 2nd sentence to read “Channelizing devices...”; move to 6F.60
- 6F.65 991 13 – 14 move to 6F.60
- 6F.65 991 35 – 36 TTC Concur.
- 6F.66 991 40 Editorial
- 6F.66 991 41 TTC Concur
- 6F.66 992 1 Editorial
- 6F.67 992 14 – 25 TTC Concur
- 6F.67 992 27 – 31 TTC Concur with modification: “...with the manufacturer’s application and installation recommendations for the ...”
- 6F.67 992 32 TTC Concur
- 6F.67 992 34-38 Delete as repetitive
- 6F.68 992 39 – 49 TTC Concur

6F.68	993	1	TTC Does not concur
6F.68	993	2 – 4	TTC Concur with modification: “...with the manufacturer’s application and installation recommendations for the ...”
6F.68	993	6 – 21	TTC Concur with modification to line 20 – “... provide positive protection for hazards, obstacles or provide positive protection for pedestrians...”
6F.69	993	22, 27	TTC Concur
6F.70	993	29 - 33	TTC Concur with modification: “... open in the same direction. And to provide continuous pedestrian channelization. ”
6F.70	993	34 – 37	TTC Concur with modification: “Temporary lane separators shall be between 64 mm (2.5 in) and 100 mm (4 in) in height and between 0.25 m (10 in) and 0.3 m (12 in) in width, and shall have sloping sides...”
6F.70	993	38 – 50	TTC Concur with modification to line 43 – “... to provide maximum nighttime ...” to line 44 – “ ... are not used, the curbing of the temporary... ” see change
6F.71	994		Delete entire section [6D.02 956 48 Change reference “6F.71” to “6F.60”]
6F.72	994	36	Editorial
6F.72	994	47 – 48	TTC Concur with modification – change in line 48 - “300 mm (12 in)” to “250 mm (10)”
6F.73	995	4, 10	TTC Concur
6F.74	995	13-18	concur
6F.74	995	19-22	concur

- 6F.74 995 25 concurs
- 6F.74 995 26 concur with modification to retain "...along pave streets and highways..."
- 6F.74 995 27 - 29 concur
- 6F.74 995 32 - 35 concur
- 6F.74 995 38 do not concur ...remove [delete all of] the non pavement...
- 6F.74 995 39 delete "...and the obliteration methods) shall minimize pavement scarring.
- 6F.74 995 42 change Guidance to read:
 Pavement marking obliteration methods should not leave scars that can appear to be a pavement marking.
- 6F.75 995 49 concur
- 6F.75 996 1-9 concur and add to the end of line 9: an exiting pavement surface, or where lanes are temporarily shifted on pavement that is to remain in place.
- 6F.75 996 11 concur with modifications: remove "an" and "study" and replace with "engineering judgment".
- 6F.75 996 12-13 concur
- 6F.75 996 16 remove "State's or highway agency's policy based on engineering judgment."
- 6F.75 996 19 -20 concur
- 6F.75 996 22-25 concur
- 6F.75 996 26 change by removing 26-27 to guidance to read:

“All pavement markings and devices used to delineate road user paths ~~shall~~ should be carefully reviewed during daytime and nighttime periods.”

6F.75	996	30	concur
6F.75	996	31	concur and <u>strike</u> the word “ calendar ”
6F.76	996	39-43	concur
6F.76	996	44-46	concur
6F.76	996	47-49	concur
6F.76	996	51-52	retain the word “temporary”: do not concur - retain original language for 51 through line 1 on page 997
6F.76	997	3	move the sentence: “The value of N referenced for solid lines shall equal the N for the broken or dotted lines that might be adjacent to or might extend the solid lines (see Section 3B.11).” and move to the end of line 8
6F.76	997	6-8	concur
6F.76	997	9-12	do not concur
6F.76	997	14-15	concur
6F.76	997	20-21	concur
6F.77	997	27-28	do not concur with the right hand and left hand
65.77	997	31-34	concur
6F.78	997	41-42	Support needs to be re-worded since they have removed most of the items in the NPA. We recommend the following wording:

There are four types of warning lights commonly used in TTC zones: Type A, Type B, Type C and Type D.

6F.78	998	1-20	TTC Does Not Concur
6F.78	998	21-32	TTC could not get a 2/3 vote
6F.78	999	3	TTC concurs
6F.79	999	11-12	TTC concurs
6F.79	999	29-35	TTC Concurs
6F.80	999	39	TTC concurs
6F.80	999	45-49	TTC concurs
6F.80	1000	8-11	TTC Concurs
6F.80	1000	49-53	TTC concurs through to 1001 lines 1 - 4
6F.81	1001	8	editorial
6F.81	1001	21- 51	TTC concurs
6F.81	1002	1-6	TTC concurs
6F.82	1002	9-44	TTC Does not concur
6F.83	1002	45-50	TTC Does not concur
6F.83	1003	1-3	TTC concurs
6F.84	1003	17	TTC concurs
6F.85	1003	35-48	TTC does not concur
6F.86	1003	49	TTC Concurs
6F.86	1004	1-9	TTC Concurs

6G.01 1005 3-9 TTC Concur

6G.01 1005 18 – 19 modify to read: “Well designed TTC plans for planned special events ~~will also likely~~ might **can** result in a combination of ...”

6G.01 1005 21 – 22 concur – note to Edit Committee to include reference to private/other facilities

6G.02 1005 35-36 TTC Concur

6G.02 1006 14-15 TTC Dues not concur, reinsert and delete “~~pay back~~”

6G.02 1006 25-26 TTC Concur

6G.04 1007 46-47 TTC Concur

6G.04 1008 17 TTC concurs – motion to modify as follows: “Temporary traffic barriers– stationary or movable “Not in NPA, not acted on

6G.04 1008 38 – 40 TTC Concur

6G.05 1009 6 Editorial

6G.06 1009 21-22 TTC Concur

6G.07 1009 45-46 TTC Concur

6G.07 1010 6-23 TTC Concur

6G.10 1011 21 Editorial

6G.11 1011 42-44 TTC Concur

6G.12 1012 31 Editorial

6G.12 1012 33-37 TTC Concur

6G.12 1012 39-40 TTC Concur

6G.12 1012 47 TTC Dues not concur

6G.12 1013 3 TTC Concur

6G.12	1013	5	TTC Concur
6G.12	1013	12	TTC Concur
6G.13	1013	48-50	TTC Concur
6G.13	1013	51	modify to read: "...to provide improved <u>adequate</u> visibility."
New		52	request that attention be paid to already NC approved work on aerial lifts
6G.13	1014	21	TTC modify to read: "...left turning or right turning ..."
6G.14	1014	46-47	TTC modify - insert to read: "...protecting work forces <u>road users and workers.</u> "
6G.18	1016	7-12	TTC Concur
6G.18	1016	13	Editorial
6G.19	1016	24	Editorial
6G.19	1017	9	insert to read: "...illumination to <u>protect workers and accomplish</u> perform the work tasks."

End of Chapter 6G

6H.01 1018 1 TTC Does not concur – return to “6I” – unanimous

- 6H.01 1018 3-10 TTC Concur
- 6H.01 1018 11-13 NC already approved this language
- 6H.01 1018 28 NC already approved this language
- 6H.01 1018 38-43 TTC Concur
- 6H.01 1018 44-47 TTC Concur
- 6H.01 1019 9 NC already approved this language
- 6H.02 1019 45 TTC modify to read: “...warning devices to alert traffic approaching the ~~back of the~~ queue.”
- 6H.02 1019 46 TTC Concur
- 6H.02 1019 47 TTC modify to read: “...to traffic approaching the ~~back of the~~ queue.”
- 6H.02 1020 5-6 TTC Concur
- 6H.02 1020 8-13 TTC Concur
- 6H.03 1020 25 TTC modify to read: “...warning devices to alert ~~road users~~ traffic approaching the ~~back of the~~ queue.”
- 6H.03 1020 27 TTC Concur
- 6H.03 1020 27-28 TTC modify to read: “...to ~~road users~~ traffic approaching the ~~back of the~~ queue.”
- 6H.03 1020 36-37 TTC Concur
- 6H.03 1020 39-44 TTC Concur

Figure 6H-1. Examples of Traffic Incident Management Area Signs

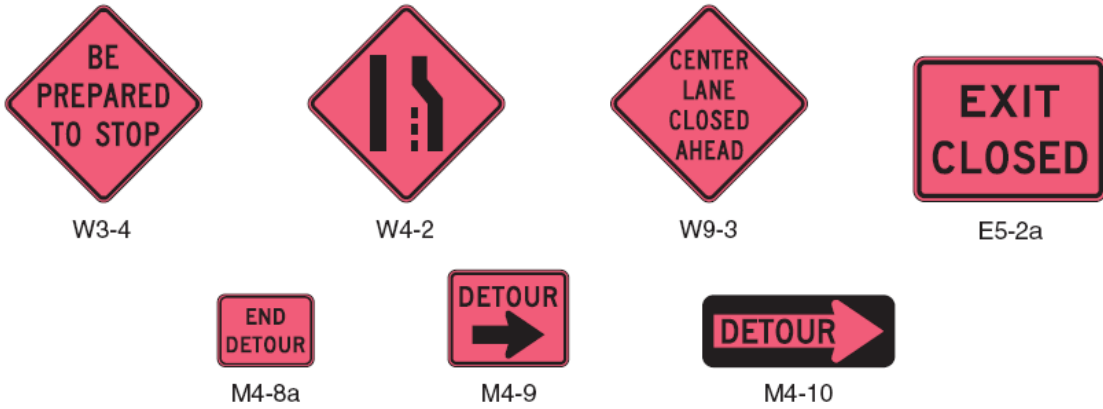

NPA Did Not Change the Figure, but TTC voted to add the following:

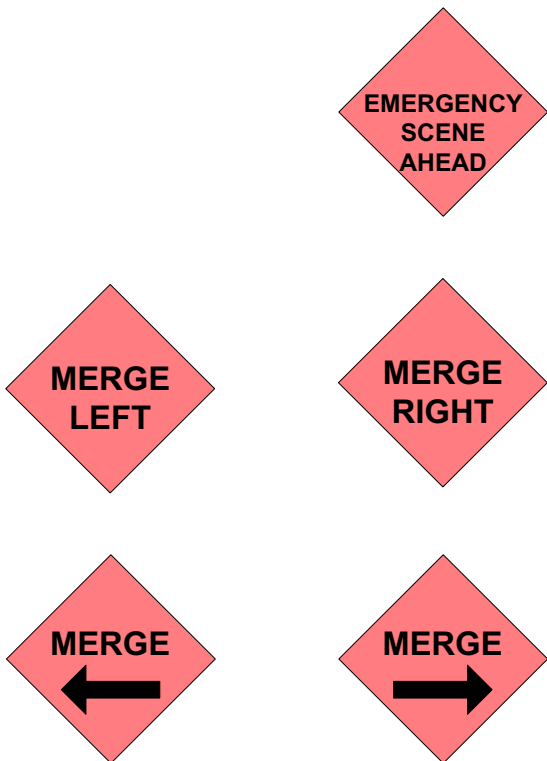

Figure 6H-1

insert diamond signs: "EMERGENCY SCENE AHEAD" and "MERGE RIGHT/LEFT"

Incident Management TAs

TTC **Strongly Request** that the Incident Management TAs as previously approved by the National Committee be included in this addition of the MUTCD– unanimous

Many incident management responders are already using parts of these TAs; as an example, the National Fire Regulations. They think is a good idea, why can't we?

6I.01 1022 1 TTC does not concur with the change in chapter numbering.

6I.01 1022 2-9 TTC Concur

6I.01 1022 21-23 TTC Concur

6I.01 1022 26 modify – “In general, the procedures illustrated represent ~~minimum~~ possible solutions for the situations depicted. Except for the notes (which are clearly classified using headings as being Standard, Guidance, Option, or Support), the information presented in the typical applications can generally be regarded as ~~Guidance~~ Option.”

6I.01 1022 34 TTC concurs

TTC concurs with all editorial replacements of “a” for “the”

6I TA4 1026 12 TTC concurs

6I TA4 1026 22-23 tabled

6I TA5 1027 10-11 TTC Concur

6I TA7 1029 7-8 editorial

6I TA8 1030 2, 8 editorial

6I TA9 1031 11 editorial

6I TA10 1032 26-28 do not concur – will not concur in any other TAs

6I TA10 1032 29 concur

6I TA11 1033 2 editorial

6I TA12 1034 2 editorial

6I TA14 1036 14-15 TTC concurs

6I TA15 1037 7-8 TTC concurs

6I	TA16	1038	4	TTC does not concur
6I	TA16	1038	5-28	TTC concur
6I	TA17	1039	2	editorial
6I	TA20	1042	2, 8	editorial
6I	TA21	1043	2	editorial
6I	TA21	1043	4-5	do not concur
6I	TA22	1044	2-9	do not concur with addition of "hand"
6I	TA23	1045	12	concur with modification ...it as a turn bay lane, the left-turn
6I	TA24	1046	9-12	concur
6I	TA25	1047	9-12	concur
6I	TA26	1048	2	concur
6I	TA27	1049	2	concur
6I	TA28	1050	2	concur
6I	TA29	1051	18	concur
6I	TA30	1052	2	concur
6I	TA31	1053	2	concur
6I	TA31	1053	24-27	change to option as follows:

Option:

"The Reverse Curve signs may contain a single reverse curve arrow or multiple reverse curve arrows with the number of arrows being the same as the number of through lanes available to road users." Note this applies to other diagrams [TA31, TA45] and 6F.47

6I	TA31	1053	30-31	do not concur
6I	TA32	1054	2	Concur
6I	TA32	1054	27-29	Concur with center line, Do not concur with hand
6I	TA 33	1055		concur
6I	TA34	1056	9-29	concur
6I	TA35	1057	17-25	concur
6I	TA 36	1058	2	concur
6I	TA36	1058	4,5	concur
6I	TA36	1058	7	concur
6I	TA36	1058	12	concur
6I	TA36	1058	16-17	concur
6I	TA36	1058	19-31	concur
6I	TA 37	1059	3-5	concur
6I	TA37	1059	8-22	concur
6I	TA 38	1060	3-7	concur
6I	TA 38	1060	11	concur
6I	TA 38	1060	12	do not concur
6I	TA 38	1060	21-22	do not concur
6I	TA 39	1061		concur to all
6I	TA 40	1062		concur to all
6I	TA 41	1063	11	insert a comma after signs to read “.. intersection guide signs, and channelizing devices ...”

- 6I TA 42 1064 16 concur with all but line 16 « hand »
- 6I TA 44 1066 7 concurs with all but line 7 “hand”
- 6I TA 45 1067 21-24 concurs
- 6I TA 45 1067 42 insert options from TA31 and insert the standard from TA 37

Option:

- 2. The procedure may be used during a peak period of vehicular traffic and then changed to provide two lanes in the other direction for the other peak.

Option:

- 9. A longitudinal buffer space may be used in the activity area to separate opposing vehicular traffic.
~~9. An ALL LANES THRU supplemental plaque may be used to emphasize the point that all lanes shift and no lanes are closed.~~
- 10. A work vehicle or a shadow vehicle may be equipped with a truck-mounted attenuator.

Standard:

- 1. An arrow panel shall be used when a freeway lane is closed. When more than one freeway lane is closed, a separate arrow panel shall be used for each closed lane.

6I TA46 1068 concur with all

TABLES concur with all

FIGURES

6I -1 314 no changes

6I -16 329 [Figure 6I-16] do not concur - delete reference to minimum 10' lane width

6I -38 351 [Figure 6I-38] TTC does not concur - when the optional cones are used, extend the temporary white edge line on the right side of the work area downstream to the end of the cones